



2018 A2 & A3 ARCHERY DEER SEASON PERMIT APPLICATION

APPLICATION INFORMATION

- Applications will be accepted as soon as they are available.
- You must use an official 2018 Archery Deer Season Permit application form. Previous year's application forms will not be considered.
- All information must be filled in completely and legibly. Incomplete or illegible applications will not be considered.
- Applicant must indicate preference: 1st choice, 2nd choice and 3rd choice.
- Priority will be given to those with past season attendance, past quality harvest selection and past regulation compliance.
- Application deadline is April 30, 2018.
- Selections will be made on May 4, 2018. You will receive confirmation via your personal method of choice.

PERMIT INFORMATION

- 1 permit per person. Permit includes 1 buck tag.
- Permit is good for hunting in Zone 1 only.
- Deer hunts are self-guided (see attached map).
- Size regulations are 15" or above spread, 40" or above girth weight.

ARCHERY SEASON DATES

- **1st Season** – September 2 – October 14
- **2nd Season** – October 15 – November 2
- **3rd Season** – November 3 – November 18
- **4th Season** – November 24 – December 9

CLASSIFICATION

- **Please self-validate your personal status in one of the following categories:**
A2 – Non-member
A3 – Member of another federally recognized native American tribe

PRICES/FEEES

- **Application fee** - \$25.00
**Include with application. Do not send permit and habitat stamp fees until you have received confirmation that you have been approved to hunt.*
- **Permit (fees)** -
1st Season - \$700.00
2nd Season - \$1,000.00
3rd Season - \$1,200.00
4th Season - \$700.00
- **Habitat stamp fee** - \$20.00
**2018 Winnebago Wildlife & Parks Habitat Stamp fee is required for all deer, turkey, small game and upland bird permits. Only one Habitat Stamp is necessary for all hunting during the 2018 season.*
- **Payment must be in the form of a money order or certified check. We do not accept cash or personal checks.**
- Mail application and payment to: Winnebago Wildlife & Parks Department, Attn: Tammy Littlewalker, P.O. Box 687, Winnebago, NE 68071.

DISCOUNTS

- **\$200.00 permit fee discount, if you book a cabin stay with us**
- **\$100.00 A3 permit fee discount**
**A3 applicants are required to submit proof of tribal enrollment, if claiming discount.*



2018 A2 & A3 ARCHERY DEER SEASON PERMIT APPLICATION

MANDATORY INFORMATION

CLASSIFICATION: A2 A3

SEASON: 1st SEASON 2nd SEASON 3rd SEASON 4th SEASON

NAME: _____ DL #: _____ M/F: _____

ADDRESS: _____ DOB (M/D/Y): ___ / ___ / _____

CITY: _____ STATE: _____ ZIP CODE: _____

TELEPHONE: (___ ___)- ___ - _____ HEIGHT: ___' WEIGHT: _____

E-MAIL: _____ EYE COLOR: _____ HAIR COLOR: _____

How long have you hunted with us? _____

Did you hunt the 2017 deer season? Yes No

If so, please describe or include photos of your harvest: _____

Once my application is processed, I would like to be notified via: Mail E-mail Telephone

I give the Winnebago Wildlife & Parks Department permission to use any photos taken or submitted during the hunting season: Yes No

I understand and agree that the Winnebago Tribe of Nebraska is not responsible for loss, accidents or injuries of any kind, resulting from or relating to my voluntary application and participation in hunting or fishing activity on tribal lands. I assume full responsibility for my acts or omissions and hereby release and forever discharge the Winnebago Tribe of Nebraska from any and all such liability and claims.

Applicant Signature: _____ DATE: _____



2018 A2 & A3 ARCHERY DEER SEASON PERMIT APPLICATION

FOR OFFICE USE ONLY

DATE RECEIVED BY WL&P OFFICE: _____

RECEIVED BY: _____

CHECKLIST: APP FEE PERMIT FEE HABITAT STAMP FEE TRIBAL ID (A3 ONLY)

DATE CONTACTED: _____

CONTACTED BY: _____

NOTES: _____

DATE COMPLETED: _____

DATE FILED: _____

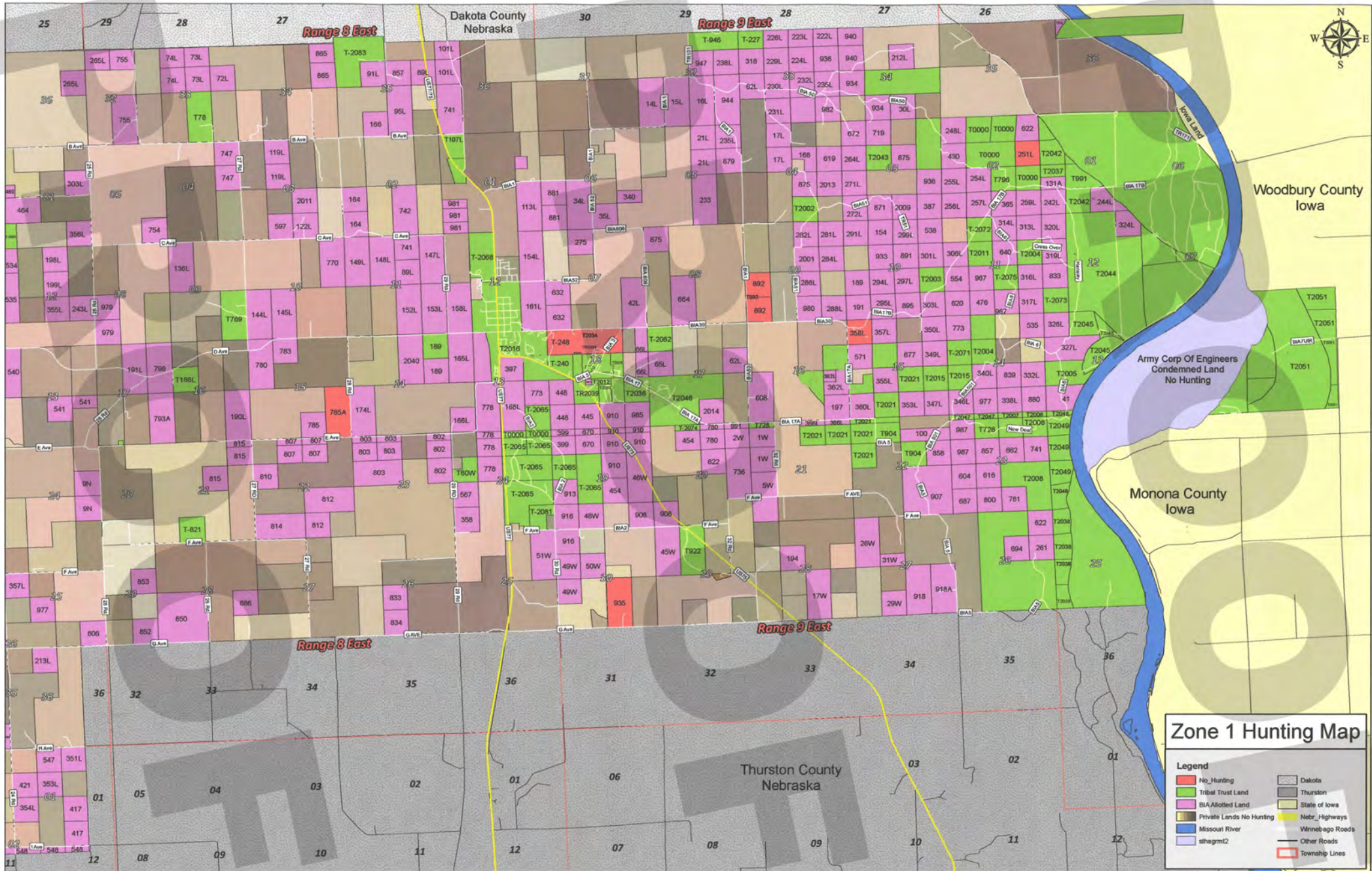

Dakota County
Nebraska



Woodbury County
Iowa

Monona County
Iowa

Thurston County
Nebraska

Army Corp Of Engineers
Condemned Land
No Hunting

Range 8 East

Range 9 East

Range 8 East

Range 9 East