



2017 A2 & A3 ARCHERY DEER SEASON (ZONE 2) PERMIT APPLICATION

APPLICATION INFORMATION

- Applications will be accepted as soon as they are available. Please assist us by applying early.
- You must use an official 2017 Deer Season Permit application form. Previous year's application forms will not be considered.
- All information must be filled in completely and legibly. Incomplete or illegible applications will not be considered.
- Application deadline is July 21, 2017.

PERMIT INFORMATION

- Permit includes: 1 doe tag and 1 either sex tag.
- Permits are available on a first-come, first-served basis. 30 permits are available for the season.
- Permit is good for hunting in Zone 2 only (see attached map).

SEASON DATES

Archery Deer Season (Zone 2) – September 2, 2017 – October 29, 2017

CLASSIFICATIONS

- **A2** – Non-tribal member.
- **A3** – Member of another federally recognized tribe.
*A3 applicants must submit a copy of their valid tribal enrollment identification card along with their application.

FEES

- **Permit fee** - \$150.00
- *\$50.00 discount for A3 applicants.
- **Habitat Stamp fee** - \$20.00
- *2017 Winnebago Wildlife & Parks Habitat Stamp fee is required for all deer, turkey, small game and upland bird permits. Only one Habitat Stamp is necessary for all hunting during the 2017 season.
- **Payment must be in the form of a money order or certified check. We do not accept cash or personal checks.**
- Submit application and fees to: Winnebago Wildlife & Parks Department, Attn: Tammy Littlewalker, P.O. Box 687, Winnebago, NE 68071

MANDATORY INFORMATION

CLASSIFICATION: A2 A3

NAME: _____

SS OR DL #: _____ M/F: _____

ADDRESS: _____

DOB (M/D/Y): ___ / ___ / _____

CITY: _____

STATE: _____ ZIP CODE: _____

TELEPHONE: (___ ___)-___-____

HEIGHT: ___'___ WEIGHT: _____

E-MAIL: _____

EYE COLOR: _____ HAIR COLOR: _____

Once my application is processed, I would like to be notified via: Mail E-mail Telephone

I give the Winnebago Wildlife & Parks Department permission to use any photos taken or submitted during the hunting season:

Yes No



2017 A2 & A3 ARCHERY DEER SEASON (ZONE 2) PERMIT APPLICATION

I understand and agree that the Winnebago Tribe of Nebraska is not responsible for loss, accidents or injuries of any kind, resulting from or relating to my voluntary application and participation in hunting or fishing activity on tribal lands. I assume full responsibility for my acts or omissions and hereby release and forever discharge the Winnebago Tribe of Nebraska from any and all such liability and claims.

APPLICANT: _____

DATE: _____

FOR OFFICE USE ONLY

DATE RECEIVED BY WL&P OFFICE: _____

RECEIVED BY: _____

CHECKLIST: PERMIT FEE HABITAT STAMP FEE

DATE CONTACTED: _____

CONTACTED BY: _____

NOTES: _____

DATE COMPLETED: _____

DATE FILED: _____

Zone 2 Hunting Map

- Legend**
- Tribal Trust Land
 - IBA Allocated Land
 - Private Land No Hunting
 - Township Lines
 - Dakota
 - Dixon
 - Thurston
 - Wayne
 - Nebr_Highways
 - Wenabago Roads
 - Other Roads

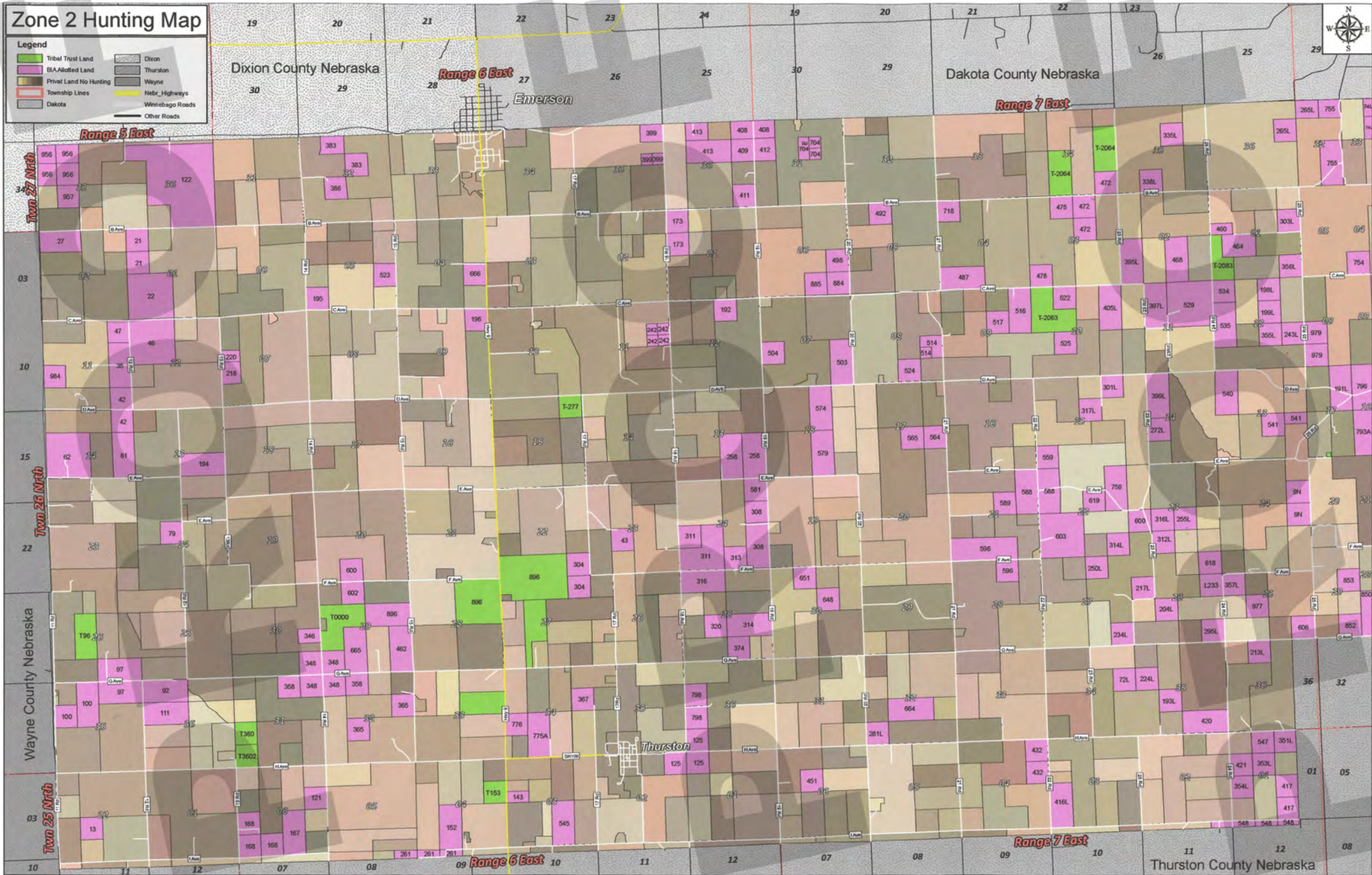

Dixon County Nebraska

Dakota County Nebraska

Range 6 East

Range 7 East

Range 5 East

Twp 27 N

03

10

15

22

Wayne County Nebraska

Twp 25 N

10

Range 6 East

Range 7 East

Thurston County Nebraska

Thurston

Emerson