



2017 A2 & A3 ARCHERY DEER SEASON PERMIT APPLICATION

APPLICATION INFORMATION

- Applications will be accepted as soon as they are available. Please assist us by applying early.
- You must use an official 2017 Deer Season Permit application form. Previous year's application forms will not be considered.
- All information must be filled in completely and legibly. Incomplete or illegible applications will not be considered.
- Application deadline is July 21, 2017.

PERMIT INFORMATION

- Permit package includes: 1 doe tag, 1 either sex tag and cabin rental.
*Note: Opting out of staying in cabins does not affect total permit price.
- Permits are available on a first-come, first-served basis. 14 permits will be available per season.
- Priority is given to groups of 2-4 people.
- Permit is good for hunting in both Zones 1 & 2 (see attached maps).

ARCHERY SEASON DATES

- **1st Season** – September 2, 2017 – September 10, 2017
- **2nd Season** – September 16, 2017 – September 24, 2017
- **3rd Season** – September 30, 2017 – October 8, 2017
- **4th Season** – October 14, 2017 – October 22, 2017
- **5th Season** – October 28, 2017 – November 5, 2017
- **6th Season** – November 6, 2017 – November 14, 2017
- **7th Season** – November 15, 2017 – November 23, 2017

CLASSIFICATIONS

- **A2** – Non-tribal member.
- **A3** – Member of another federally recognized tribe.
*A3 applicants must submit a copy of their valid tribal enrollment identification card along with their application.

FEES

- **Security deposit fee** - \$200.00
*This fee is non-refundable and secures your permit for the 2017 Archery Deer Season.
- **Permit fee** - \$1000.00
- *\$100.00 discount for A3 applicants. Security deposit can be deducted from permit fee, once paid in full. (ex. \$1000.00 - \$200.00 = \$800.00 due)
- **Habitat Stamp fee** - \$20.00
*2017 Winnebago Wildlife & Parks Habitat Stamp fee is required for all deer, turkey, small game and upland bird permits. Only one Habitat Stamp is necessary for all hunting during the 2017 season.
- **Payment must be in the form of a money order or certified check. We do not accept cash or personal checks.**
- Submit application and fees to: Winnebago Wildlife & Parks Department, Attn: Tammy Littlewalker, P.O. Box 687, Winnebago, NE 68071



2017 A2 & A3 ARCHERY DEER SEASON PERMIT APPLICATION

MANDATORY INFORMATION

CLASSIFICATION: A2 A3
SEASON: 1st SEASON 2nd SEASON 3rd SEASON 4th SEASON
 5th SEASON 6th SEASON 7th SEASON

NAME: _____ SS OR DL #: _____ M/F: _____
ADDRESS: _____ DOB (M/D/Y): ____ / ____ / ____
CITY: _____ STATE: _____ ZIP CODE: _____
TELEPHONE: (____)- ____ - _____ HEIGHT: ____' WEIGHT: ____
E-MAIL: _____ EYE COLOR: _____ HAIR COLOR: _____

Once my application is processed, I would like to be notified via: Mail E-mail Telephone

I give the Winnebago Wildlife & Parks Department permission to use any photos taken or submitted during the hunting season:

 Yes No

I understand and agree that the Winnebago Tribe of Nebraska is not responsible for loss, accidents or injuries of any kind, resulting from or relating to my voluntary application and participation in hunting or fishing activity on tribal lands. I assume full responsibility for my acts or omissions and hereby release and forever discharge the Winnebago Tribe of Nebraska from any and all such liability and claims.

APPLICANT: _____ DATE: _____



2017 A2 & A3 ARCHERY DEER SEASON PERMIT APPLICATION

FOR OFFICE USE ONLY

DATE RECEIVED BY WL&P OFFICE: _____

RECEIVED BY: _____

CHECKLIST: SECURITY DEPOSIT PERMIT FEE

HABITAT STAMP FEE

DATE CONTACTED: _____

CONTACTED BY: _____

NOTES: _____

DATE COMPLETED: _____

DATE FILED: _____

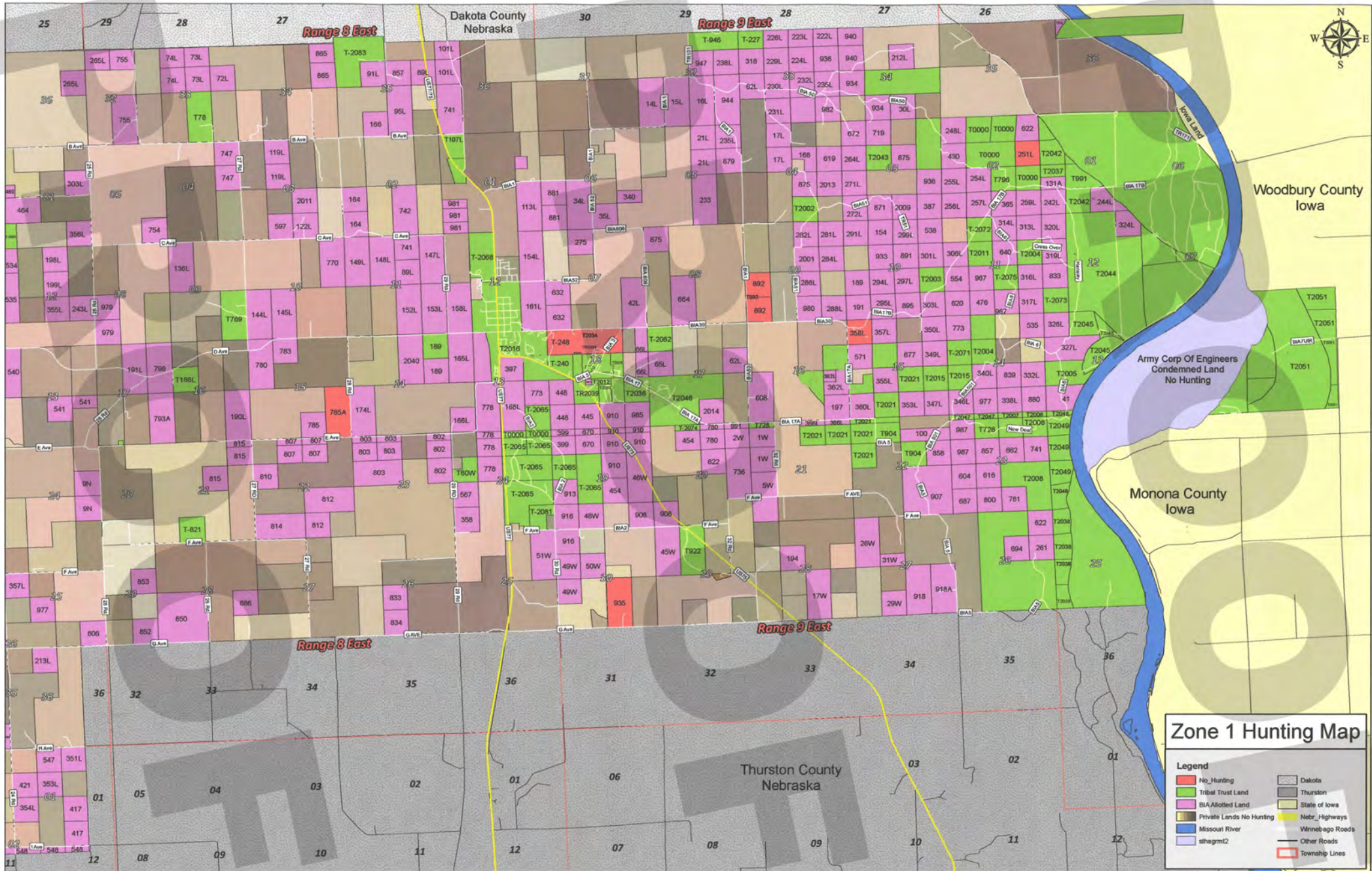

Dakota County
Nebraska

Woodbury County
Iowa

Monona County
Iowa

Thurston County
Nebraska

Army Corp Of Engineers
Condemned Land
No Hunting

Range 8 East

Range 9 East

Range 8 East

Range 9 East

Zone 2 Hunting Map

- Legend**
- Tribal Trust Land
 - BLA Allocated Land
 - Private Land No Hunting
 - Township Lines
 - Dakota
 - Dixon
 - Thurston
 - Wayne
 - Nebr_Highways
 - Wenabago Roads
 - Other Roads

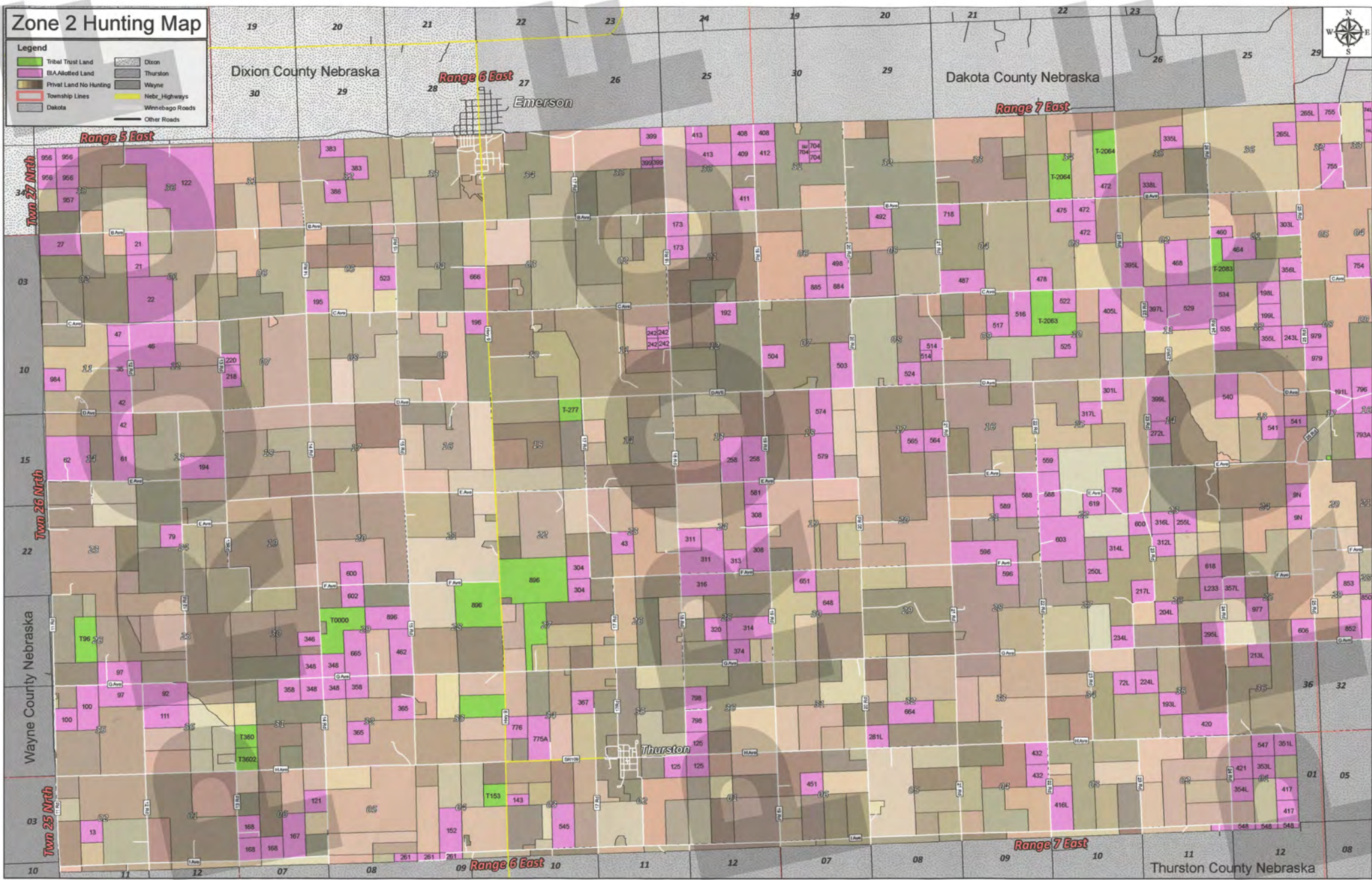

Dixon County Nebraska

Dakota County Nebraska

Range 6 East

Range 7 East

Range 5 East

Town 27 North

Town 26 North

Wayne County Nebraska

Town 25 North

Thurston

Range 6 East

Range 7 East

Thurston County Nebraska